

Through-Glass Robe Hook 6880-5G-82CP

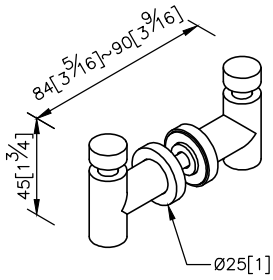

- 1.Brass of mounting base and hooks meet JIS 3604 standard.
- 2.Brass of forging brackets meet JIS 3771 standard.
- 3.Justime finishes resist corrosion and tarnish.
- 4.Chrome plated finish meets the standard of ASTM-SC2.
- 5.Vertical force could support a static load of 5 Kgf.
- 6.The robe hook is specially designed for the glass partition, it could provide more stability during the operation. And double hooks improve more convenience.
- 7.Coordinates with other products in 6880 collection.

unit: mm[inch]

