

Still One

Robe Hook 7806-50-80S1

INTRODUCTION:

The compact brushed base was designed with column shape, staggered lines disseminate a real sense of stability.



DESCRIPTION:

1. Stainless Steel body meets SUS 304 standard.
2. Premium metal construction for durability.
3. Justime finishes resist corrosion and tarnish.
4. Vertical force could support a static load of 5 kgf.
5. Coordinates with other products in Still One collection.

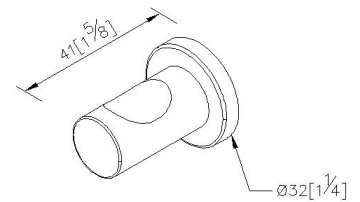

Certification:

unit: mm[inch]

Fixing Kits:

1. SUS 304 Stainless Steel Screws*2
2. Hex Key 1/8"*1
3. Plastic Anchors*2

AWARD: