

Bath Towel Rack

7806-65-80S1

1. Stainless Steel body meets SUS 304 standard.
2. Premium metal construction for durability.
3. Justime finishes resist corrosion and tarnish.
4. Vertical force could support a static load of 5 kgf.
5. Coordinates with other products in Still One collection.

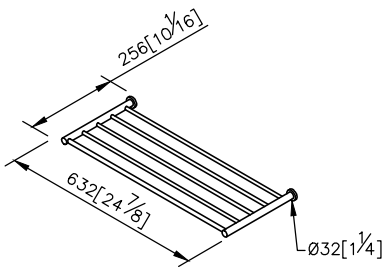

unit: mm[inch]

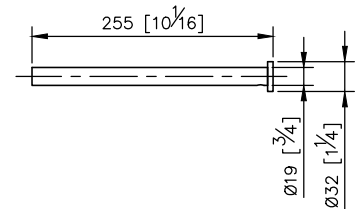
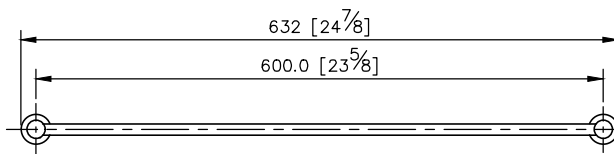
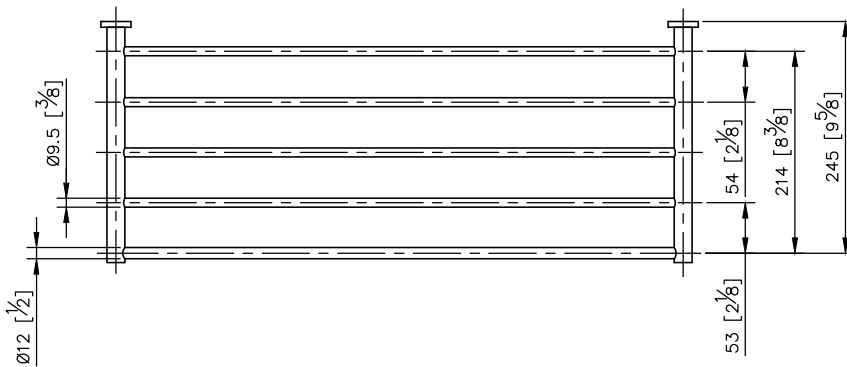

Mounting Template Specification

